

Driver LC 60W 900–1750mA flexC C EXC

excite series

**Product description**

- _ Constant current LED driver
- _ Adjustable output current between 900 and 1,750 mA via ready2mains Programmer or I-SELECT 2 plugs
- _ Max. output power 60 W
- _ Up to 90 % efficiency
- _ Nominal lifetime up to 100,000 h
- _ 5 years guarantee

Housing properties

- _ Casing: polycarbonate, white
- _ Type of protection IP20

Interfaces

- _ ready2mains (configuration via mains)
- _ Terminal blocks: 45° push terminals

Functions

- _ Adjustable output current in 1-mA-steps (ready2mains, I-SELECT 2)
- _ Protective features (overtemperature, short-circuit, overload, no-load, input voltage range)
- _ Intelligent Voltage Guard (overvoltage and undervoltage monitoring)
- _ Suitable for emergency escape lighting systems acc. to EN 50172

Benefits

- _ Application-oriented operating window for maximum compatibility
- _ Best energy savings due to high efficiency
- _ Flexible configuration via ready2mains and I-SELECT 2

Typical applications

- _ For downlight, spotlight and decorative applications

Website

<http://www.tridonic.com/28000696>



Spotlights



Downlights



Linear



Area



Floor | Wall



Free-standing



Street



Decorative



High bay

Driver LC 60W 900–1750mA flexC C EXC

excite series

The complete data sheet for this product is available in the Downloads section.

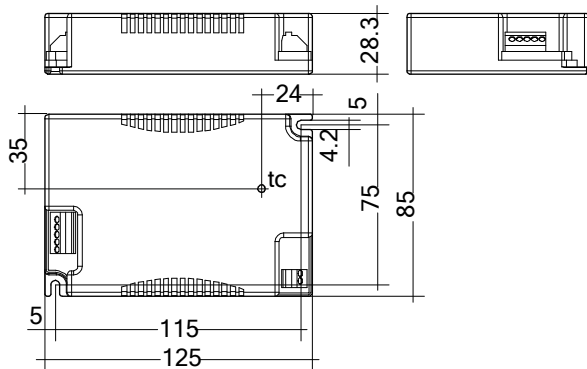
**Ordering data**

Type	Article number	Packaging, carton	Packaging, pallet	Weight per pc.
LC 60W 900-1750mA flexC C EXC	28000696	10 pc(s).	720 pc(s).	0.201 kg

Technical data

Rated supply voltage	220 – 240 V
AC voltage range	198 – 264 V
DC voltage range	176 – 280 V
Mains frequency	0 / 50 / 60 Hz
Overvoltage protection	320 V AC, 48 h
Typ. rated current (at 230 V, 50 Hz, full load) ^①	306 mA
Typ. current (220 V, 0 Hz, full load, 50 % dimming level) ^①	137 mA
Leakage current (at 230 V, 50 Hz, full load) ^①	< 250 μ A
Max. input power	67 W
Typ. efficiency (at 230 V, 50 Hz, full load) ^①	90 %
λ (at 230 V, 50 Hz, full load)	0.95
Typ. input current in no-load operation	19.5 mA
Typ. input power in no-load operation	0.08 W
In-rush current (peak / duration)	25.9 A / 252 μ s
THD (at 230 V, 50 Hz, full load)	< 10 %
Starting time (at 230 V, 50 Hz, full load)	< 500 ms
Starting time (DC mode)	< 500 ms
Switchover time (AC/DC) ^②	< 0.2 s
Turn off time (at 230 V, 50 Hz, full load)	< 50 ms
Output current tolerance ^③	\pm 5 %
Max. output current peak (non-repetitive)	\leq output current + 35 %
Output LF current ripple (< 120 Hz)	\pm 5 %
Output P_ST_LM (at full load)	\leq 1
Output SVM (at full load)	\leq 0.4
Max. output voltage (U-OUT)	60 V
Mains surge capability (between L - N)	1 kV
Mains surge capability (between L/N - PE)	2 kV
Burst / surge peaks output side against PE	< 500 V
Type of protection	IP20
Lifetime	up to 100,000 h
Guarantee	5 Year(s)
Dimensions L x W x H	125 x 85 x 28.3 mm

Approval marks**Standards**

EN 55015, EN 61000-3-2, EN 61000-3-3, EN 61347-1, EN 61347-2-13, EN 62384, EN 61547, according to EN 50172, according to EN 60598-2-22

Specific technical data

Type	Output current ^④	Min. output voltage	Max. output voltage	Max. output power	Typ. power consumption n (at 230 V, 50 Hz, full load)	Typ. current consumption n (at 230 V, 50 Hz, full load)	tc point max.	Ambient temperature ta	I-SELECT2 resistor value ^⑤
LC 60W 900-1750mA flexC C EXC	900 mA	20 V	54.0 V	48.6 W	53.8 W	241 mA	85 °C	-25 ... +50 °C	-
LC 60W 900-1750mA flexC C EXC	950 mA	20 V	54.0 V	51.3 W	57.0 W	255 mA	85 °C	-25 ... +50 °C	5.26 k Ω
LC 60W 900-1750mA flexC C EXC	1,000 mA	20 V	54.0 V	54.0 W	59.5 W	265 mA	85 °C	-25 ... +50 °C	5.00 k Ω
LC 60W 900-1750mA flexC C EXC	1,050 mA	20 V	54.0 V	56.7 W	62.8 W	279 mA	85 °C	-25 ... +50 °C	4.76 k Ω
LC 60W 900-1750mA flexC C EXC	1,100 mA	20 V	54.0 V	59.4 W	64.7 W	291 mA	85 °C	-25 ... +50 °C	4.55 k Ω
LC 60W 900-1750mA flexC C EXC	1,150 mA	20 V	52.2 V	60.0 W	65.5 W	294 mA	80 °C	-25 ... +50 °C	4.35 k Ω
LC 60W 900-1750mA flexC C EXC	1,200 mA	20 V	50.0 V	60.0 W	65.7 W	292 mA	80 °C	-25 ... +50 °C	4.17 k Ω
LC 60W 900-1750mA flexC C EXC	1,250 mA	20 V	48.0 V	60.0 W	66.7 W	306 mA	80 °C	-25 ... +50 °C	4.00 k Ω
LC 60W 900-1750mA flexC C EXC	1,300 mA	20 V	46.2 V	60.0 W	66.4 W	295 mA	80 °C	-25 ... +50 °C	3.85 k Ω
LC 60W 900-1750mA flexC C EXC	1,350 mA	20 V	44.4 V	60.0 W	66.1 W	303 mA	80 °C	-25 ... +50 °C	3.70 k Ω
LC 60W 900-1750mA flexC C EXC	1,400 mA	20 V	42.9 V	60.0 W	66.1 W	294 mA	80 °C	-25 ... +50 °C	3.57 k Ω
LC 60W 900-1750mA flexC C EXC	1,450 mA	20 V	41.4 V	60.0 W	66.6 W	306 mA	80 °C	-25 ... +50 °C	3.45 k Ω
LC 60W 900-1750mA flexC C EXC	1,500 mA	20 V	40.0 V	60.0 W	66.8 W	296 mA	80 °C	-25 ... +50 °C	3.33 k Ω
LC 60W 900-1750mA flexC C EXC	1,550 mA	20 V	38.7 V	60.0 W	66.7 W	298 mA	80 °C	-25 ... +50 °C	3.23 k Ω
LC 60W 900-1750mA flexC C EXC	1,600 mA	20 V	37.5 V	60.0 W	66.4 W	295 mA	80 °C	-25 ... +50 °C	3.13 k Ω
LC 60W 900-1750mA flexC C EXC	1,650 mA	20 V	37.5 V	60.0 W	66.0 W	303 mA	80 °C	-25 ... +50 °C	3.03 k Ω
LC 60W 900-1750mA flexC C EXC	1,700 mA	20 V	35.3 V	60.0 W	66.8 W	297 mA	80 °C	-25 ... +50 °C	2.94 k Ω
LC 60W 900-1750mA flexC C EXC	1,750 mA	20 V	34.3 V	60.0 W	66.8 W	297 mA	80 °C	-25 ... +50 °C	0.00 k Ω

^① Depending on the selected output current.

^② Valid for immediate change of power supply type otherwise the starting time is valid.

^③ Output current is mean value.

^④ The table only lists a number of possible operating points but does not cover each single point. The output current can be set within the total value range in 1-mA-steps.

^⑤ Not compatible with I-SELECT (generation 1). Calculated resistor value.